

3:BAUD HILL\CD\drainage\mga\1-07.dwg, developed, 2/21/2007 3:56:47 PM, C:\s\BUD\NGC1 & 2.dwg, Layer 1 (8/8/01, 24.00 inches), 1:1

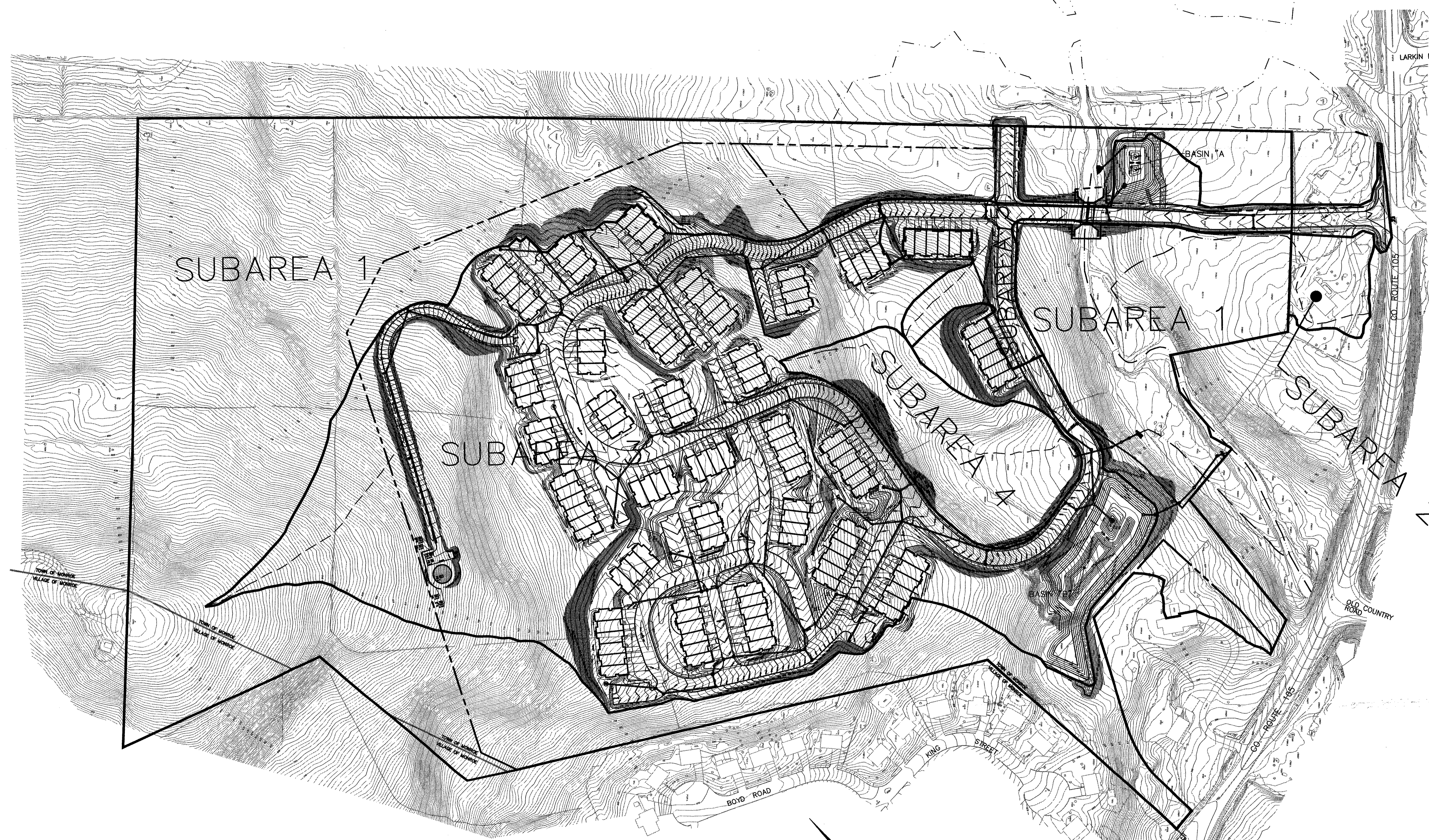

DRAINAGE AREA DELINEATION —————
TIME OF CONCENTRATION FLOW PATH - - - - -
HYDROGRAPH LAG TO POINT OF INTEREST - · - · -

NOTES:
1. TIME OF CONCENTRATION FLOW PATH ENTERS THE PROPOSED STORM DRAINAGE SYSTEM WHEN IT INTERSECT THE PROPOSED ROADWAY.
2. ALL ROOF LEADERS WILL BE DISCHARGED INTO THE STORM DRAINAGE SYSTEM.

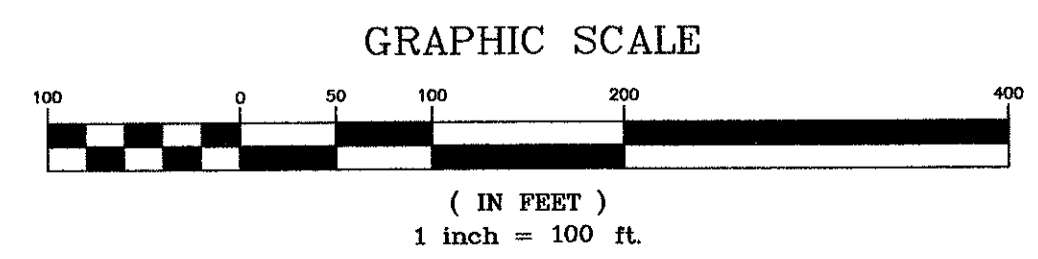

LEONARD JACKSON ASSOCIATES		LEONARD JACKSON, P.E. N.Y.S. Lic. No. 42167	
LEONARD JACKSON ASSOCIATES		CONSULTING ENGINEERS	
26 FREEMAN MEMORIAL DRIVE, POMONA, NEW YORK 10970		phone: (845) 354-4382 fax: (845) 354-4401	
BALD HILL ESTATES		LJA	
TOWN OF MONROE ORANGE COUNTY, NY			
DEVELOPED CONDITIONS DRAINAGE AREA PLAN			
Job number:	00046	GENERAL REVISIONS	2/1/07
Drawn by:	JS	GENERAL REVISIONS	4/5/06
Date:	10/03/03	AS PER CONSULTANTS' COMMENTS	11/15/05
Scale:	1"=100'	AS PER CONSULTANTS' COMMENTS	1/17/05
Drawing Number:	DEV	AS PER CONSULTANTS' COMMENTS	8/10/04
		REV.	DATE